

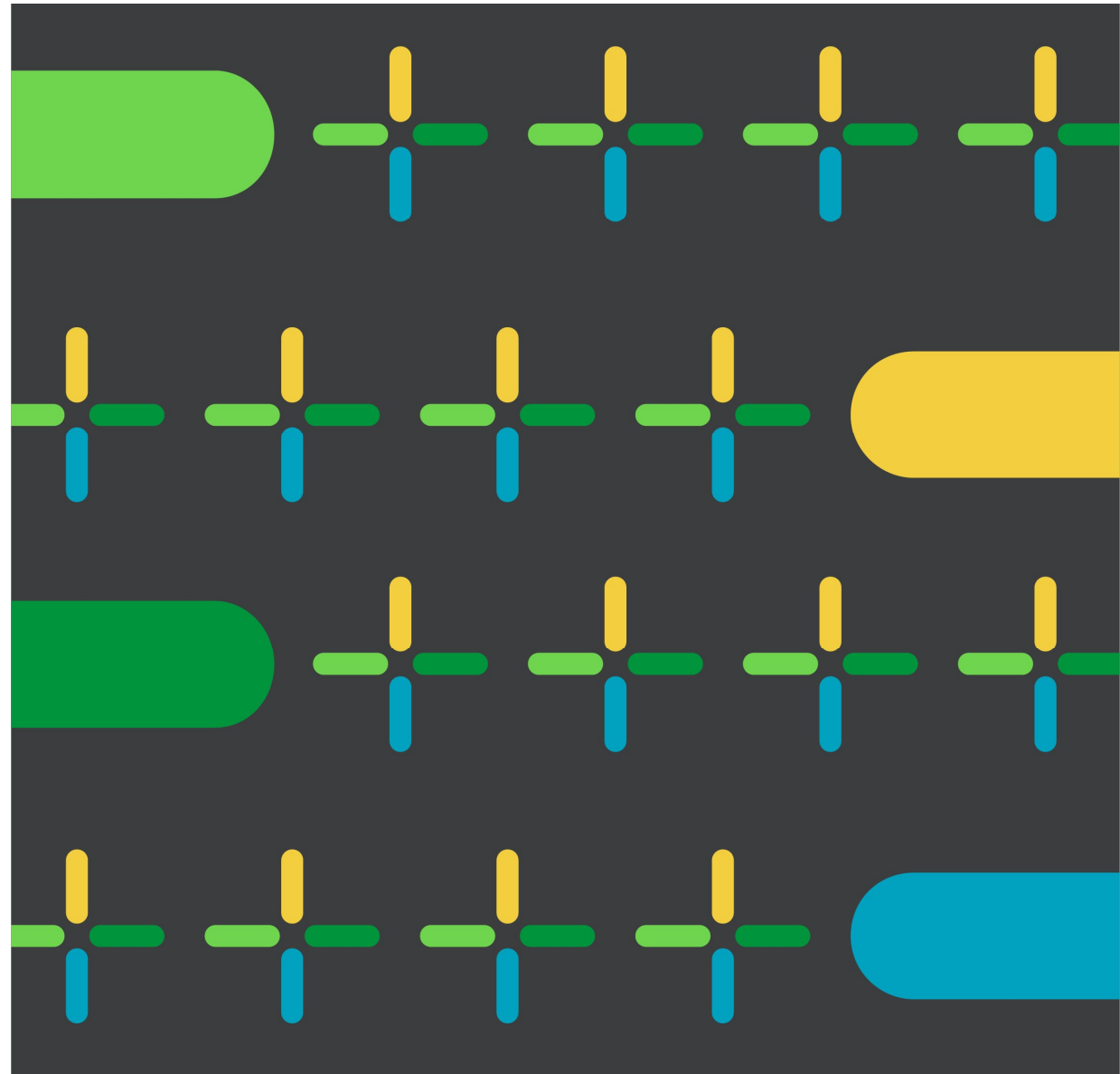

Sachertorte and  
Vertex: what do they  
have in common?

14 June 2023, Vienna



Das Geheimnis der Sacher-Torte: Warum es Sie heute noch gibt



 **VERTEX**

Pic courtesy to Sacher

## The Sacher-torte: Something new was required

- 1832 – Prince Klemens Wenzel von Metternich needed a dessert that would **live up to the highest standards** of his special guests
- Franz Sacher (16 years old) was asked to create the dessert that “**wouldn’t disgrace the Prince** that evening”
- Franz realized that the traditional deserts would **not be able to fulfil this request**, he knew that he had to come up with something new.
- Franz Sacher created an outstanding desert that was deemed “**presentable at court**”
- Because of the high quality it became a **standard in the world**
- Because of the **continued high quality**, in 2023, **after 191 years, it is still a standard in the world**

## SAP S/4HANA and ViDa: Something new is required

- 2023 – The world of VAT is becoming more and more digital, and the transaction VAT data needs to **live up to the highest compliance standards**
- More and more countries are requesting data transfers in (almost) real-time: Accurate and Compliant “that **doesn’t disgrace the company**”
- Companies realize that the traditional, home grown VAT determination solutions are **not able to fulfil this request**
- A Tax Engine is designed to create first time right data, that is deemed “**presentable at tax authorities**”
- Because of the high-quality output, it is becoming rapidly the **new standard for use with SAP S/4HANA**
- Because of the continued high investments made in keeping up with the latest standards (IT and ViDA), it is **expected to be around for many decades to come**

Are you migrating to SAP S/4HANA?



# Some benefits of SAP S/4HANA

- Easier to update business models
- Simpler to bring acquisitions into the ERP environment
- Lower ownership costs
- Faster analytical insights
- More accurate forecasting
- Speedier period-end closings
- Assets maintained proactively
- Simpler user interface
- Tedious tasks automated



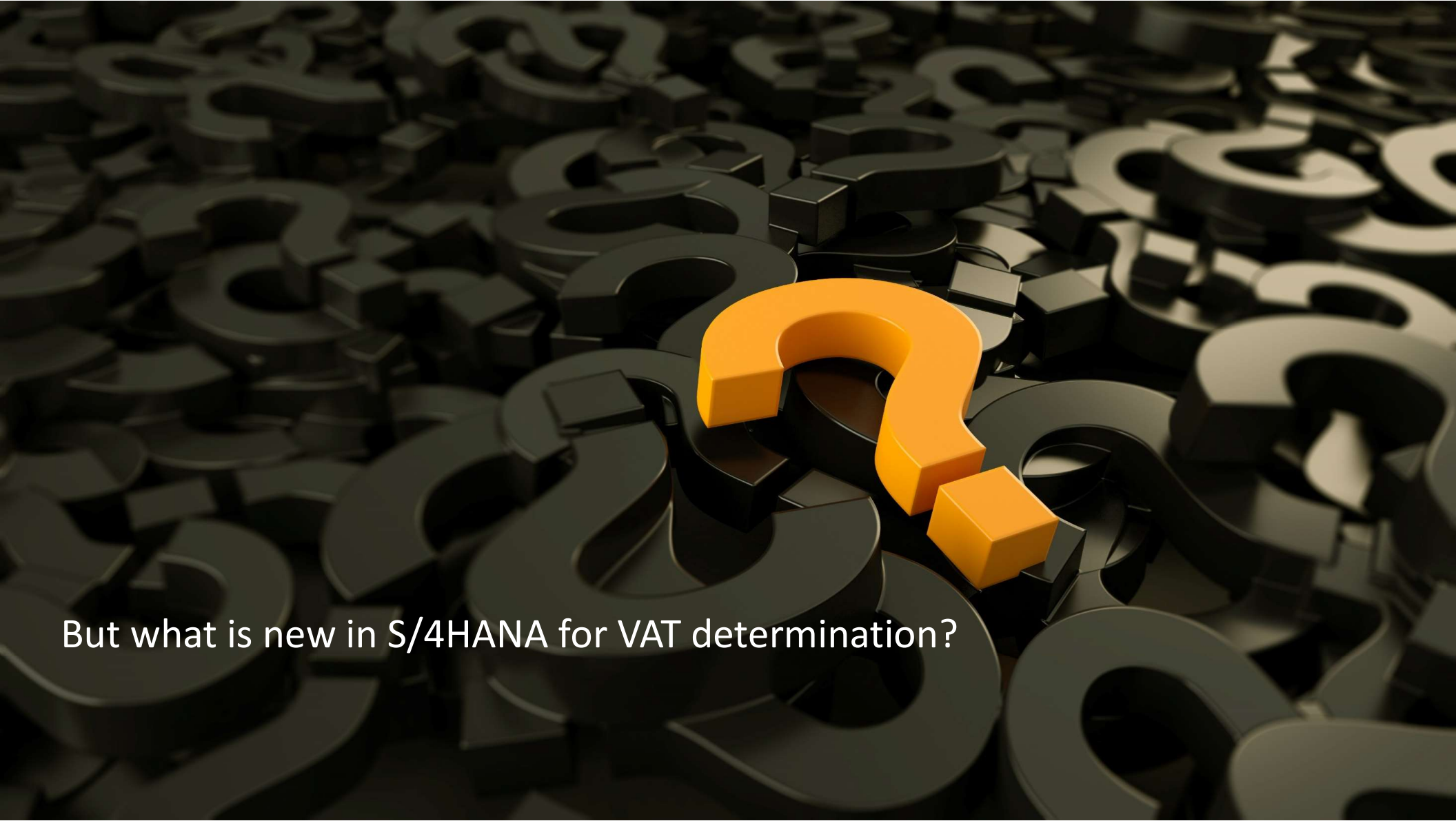

But what is new in S/4HANA for VAT determination?

# The initial design, >30 years ago: Sales transactions

Access sequence 1: Cross border scenario



Access sequence 2: If it was not a Cross border scenario, it is a domestic transaction



Access sequence 3: If it was not a Domestic scenario, it must have been a Cross border scenario



# The current design in S/4HANA: Sales transactions

Access sequence 1: Cross border scenario



Access sequence 2: If it was not a Cross border scenario, it is a domestic transaction



Access sequence 3: If it was not a Domestic scenario, it must have been a Cross border scenario





# The current VAT determination functionality in S/4HANA

Robust framework for A-B transactions:

- Domestic transactions
  - if party A is established in the country
  - if no exemption certificates apply
  - if not within a VAT group
- Intra Community Supplies of goods
  - if correct legal partner for VAT is determined
- Export transactions

How  
complex is  
your  
business?

## Your VAT challenge is broader than native SAP alone



# We connect more financial platforms to S/4HANA than ever!

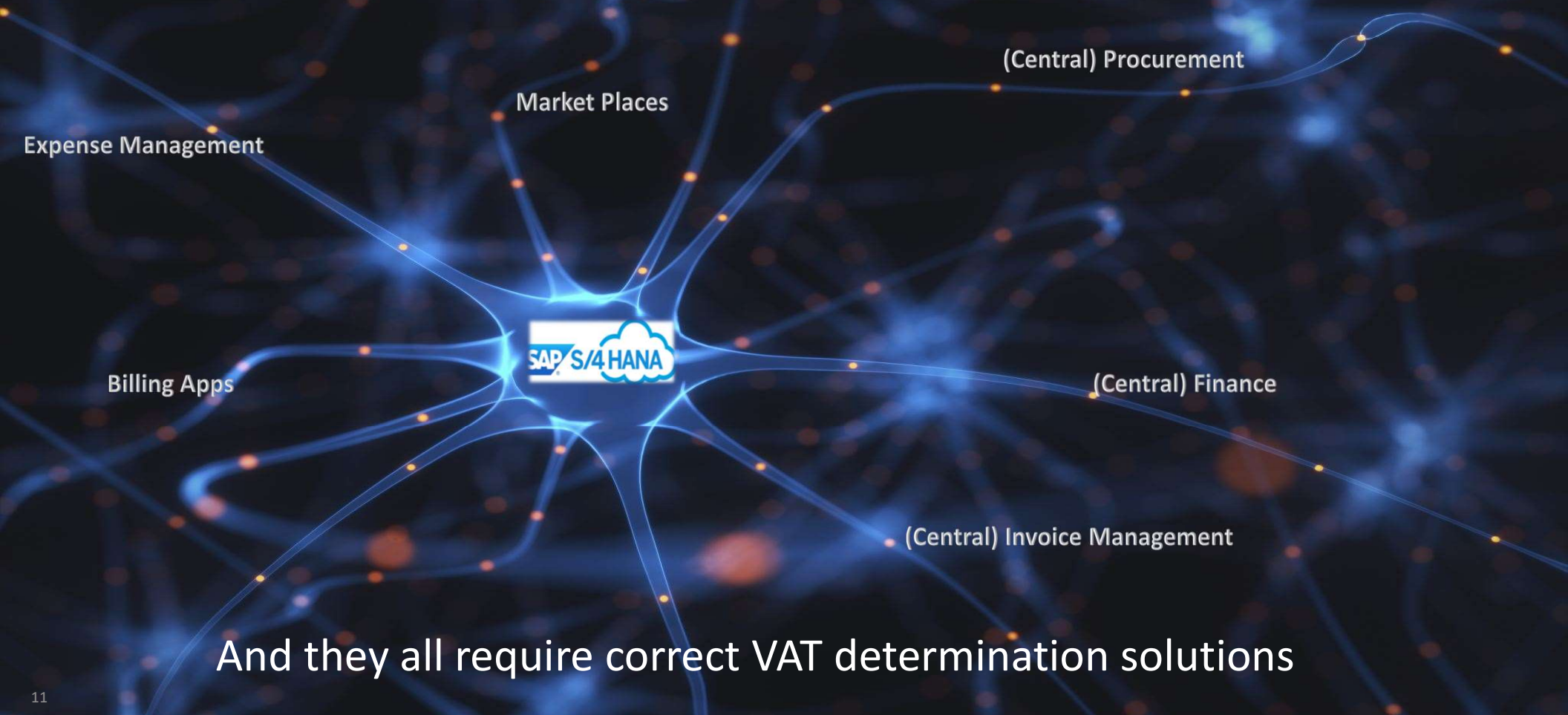

And they all require correct VAT determination solutions

# ViDA, e-invoicing, e-filing: Data must be first time right!

ITR

Direct Tax

Indirect Tax

Transfer Pricing

Jurisdictions

Expert Analysis

Events

## Viva la ViDA? Will the EU's grand plan for VAT be as revolutionary as promised?

Sponsored by



By *Peter Boerhof* February 17, 2023





Staffing S/4HANA projects

There are numerous SAP consultants globally



The background of the slide is a dense, repeating pattern of small, five-pointed stars in red, white, and blue, resembling confetti or a decorative paper. A light blue horizontal bar is positioned across the upper portion of the image, containing the text.

But there are also numerous S/4HANA migrations

# SAP Indirect Tax Specialists worldwide: Are they available for your project?

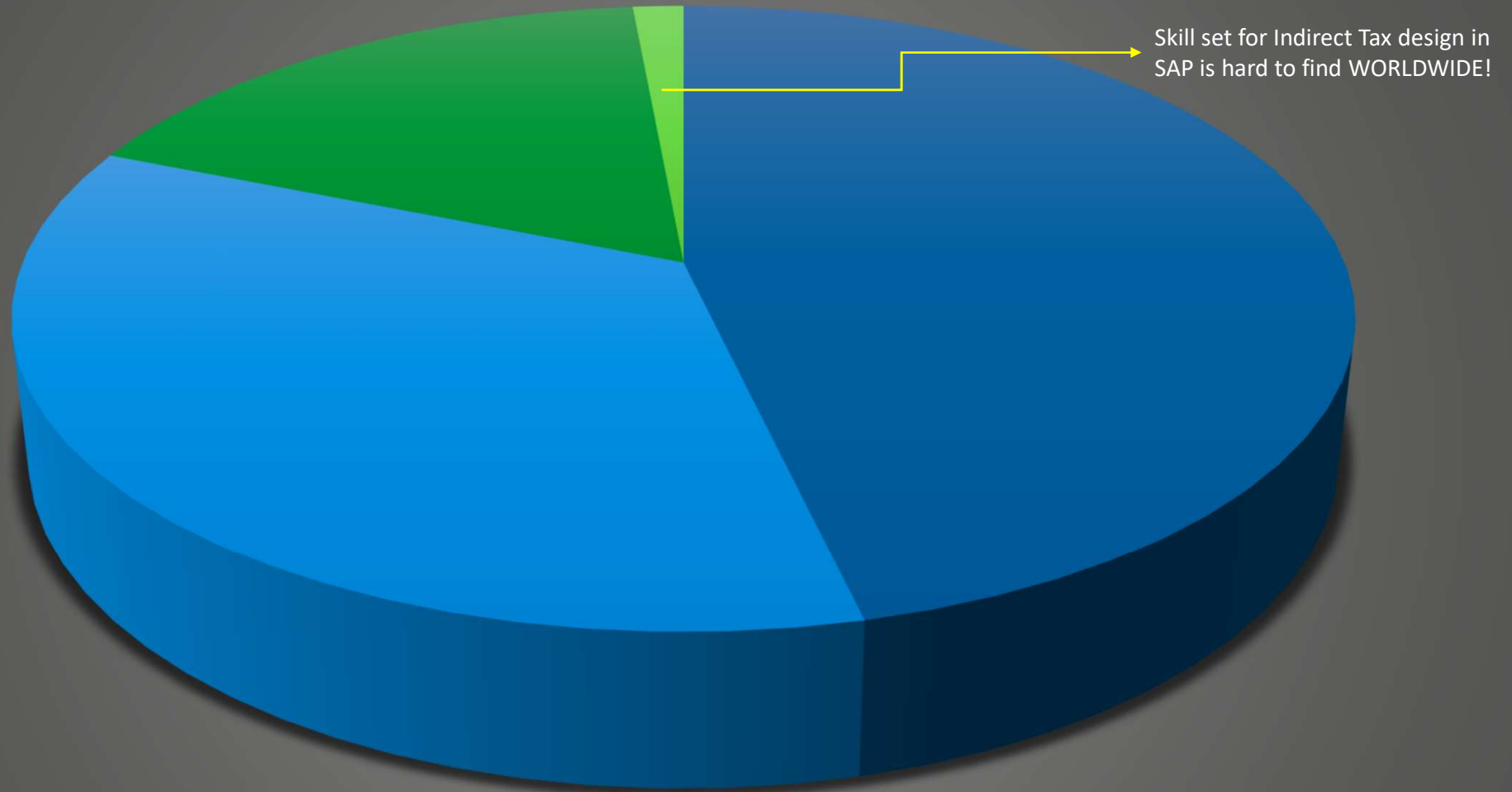



Language



# Solutioning Indirect Tax in SAP: Does everybody speak the same “language”?

Do we get a correct level of understanding if staff with different professional backgrounds talk with each other?

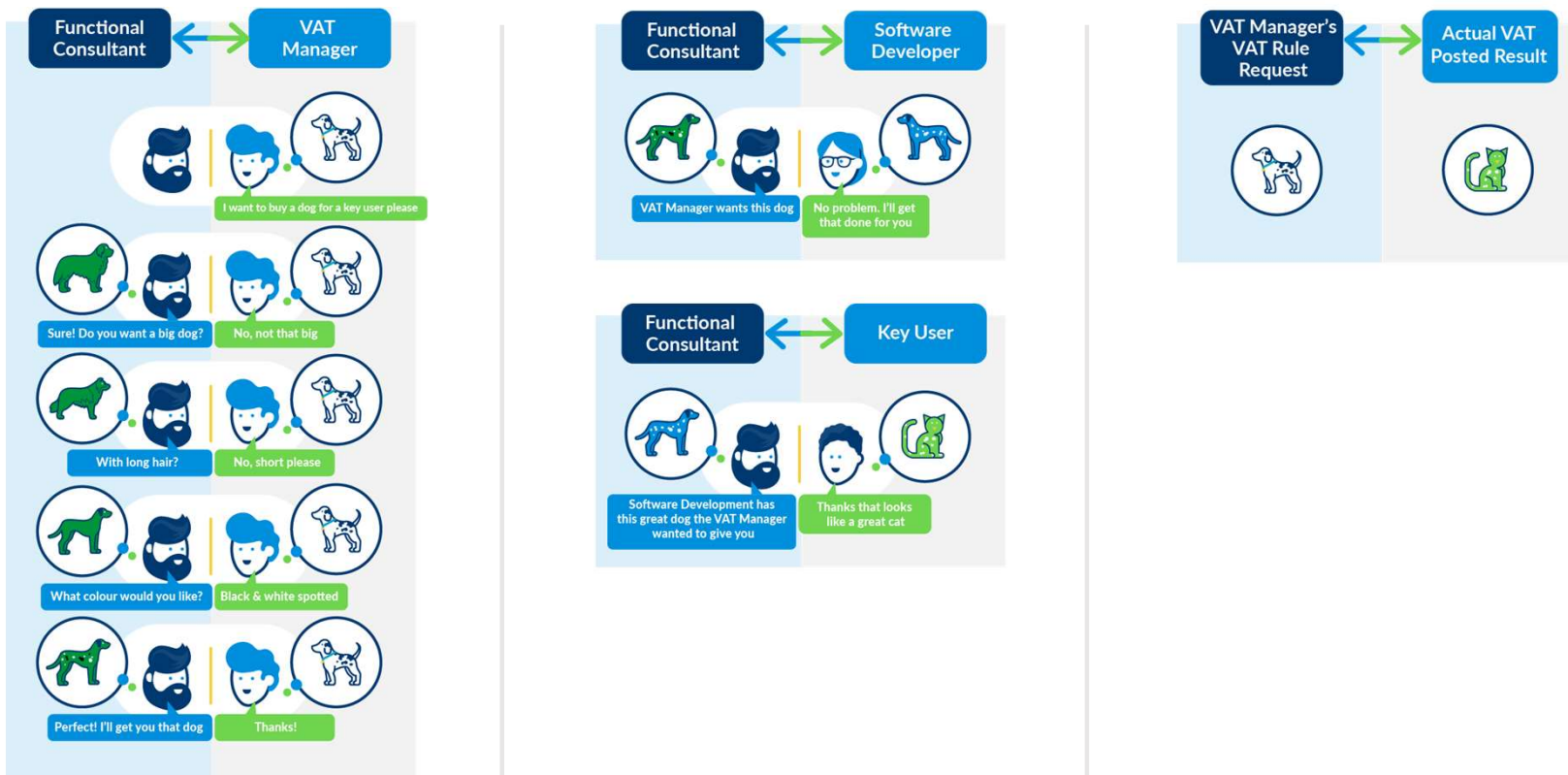



**Don't just paint the leaves green, fix the roots for a healthy tree**  
***Fix the root causes, "work-arounds" and "plasters" are no longer an option***  
***Implement your tax process correctly, don't "just" make it work....***

Spending your budget wisely



What comes first.....?





A chain is only strong if all links are strong.....

Reports are only correct if all underlying data is correct

A chessboard with several pieces, including a king, a queen, a rook, and a pawn, set against a light blue background. The pieces are arranged on a checkered board, with the king and queen in the center, a rook to the left, and a pawn in the foreground. The background is a soft, light blue gradient.

Are VAT determination cost in  
S/4HANA transparent to you?

# VAT determination cost in S/4HANA transparent?

Business case calculations, project plans, Statements of Work, budget calculations....

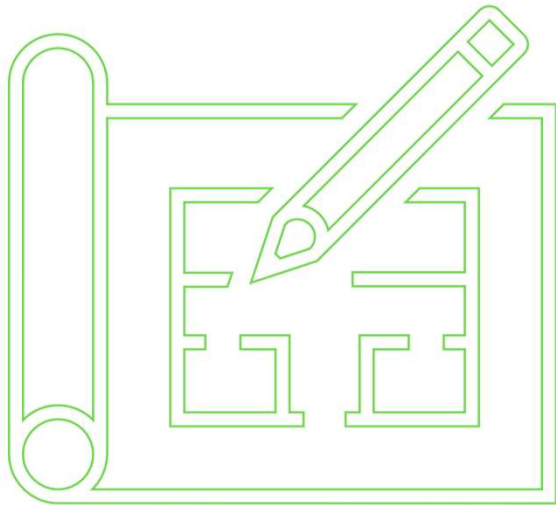

Total budget \$ xx.xxx.xxx

Tax Engine implementation cost: \$ xxx.xxx

**Additional cost or not?**

Did your implementation plan contain transparent VAT determination cost?



Often SAP S/4HANA implementation projects don't state a realistic calculation for implementing fully automated and compliant VAT determination process.

VAT determination cost are famous "Hidden Cost"; a well-kept secret in many organizations





# Determining the legal partner for VAT purposes in SAP



What does it take to ensure we always determine the correct “Legal partner for VAT purposes” in a sales transaction in SAP?

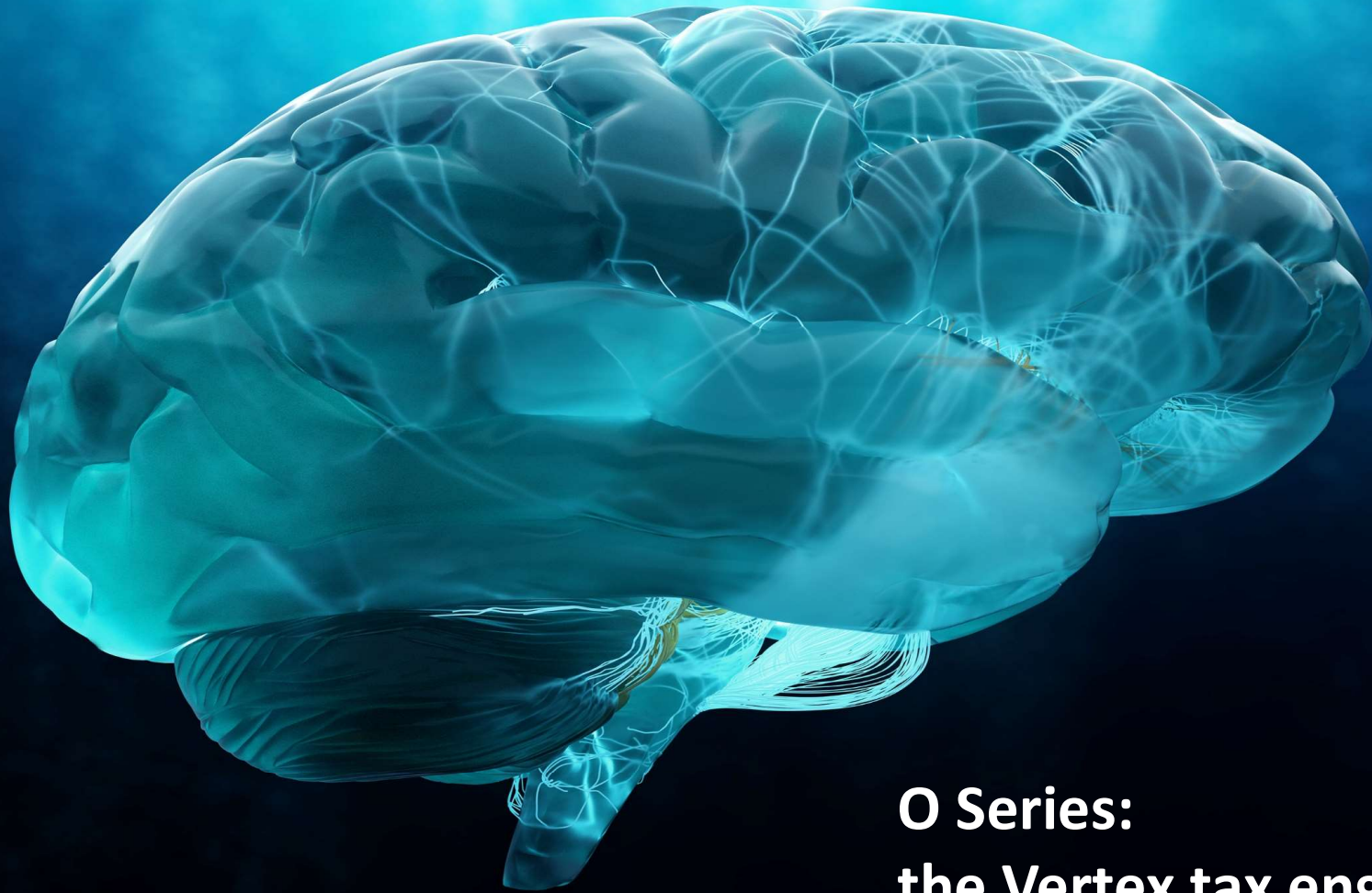

**O Series:  
the Vertex tax engine**

# O Series – Vertex’s flagship

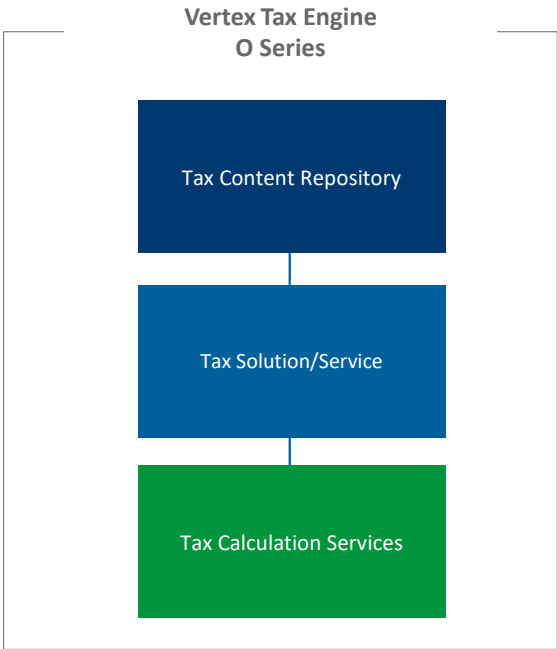

# Vertex O Series content: Indirect tax rules & rates

- Jurisdictional content
  - + Coverage of Federal Level Taxes and Sub-jurisdictional treatment
  - + What is/isn't in the European Union
    - Aegean Islands; French DOMTOMS; Canaries; Ceuta/Melilla etc
- Place of supply content
  - + Goods v services
  - + Different types of service
  - + Complex areas of place of supply
- Related VAT functionality
  - + Exceptional Supplier/Customer treatment
    - Net exporters; qualifying disabled; research charities; NATO etc
  - + Recoverability – Blocking Orders and Partial Exemption

## Examples of EU specific VAT content

- Chain transactions with multiple parties involved
- EU triangulation
- Domestic and extended reverse charge
- High Seas/ Out of the scope for VAT transactions
- VAT groups
- Major exporter schemes (Italy, France, Ireland)
- Free trade zones / Bonded / VAT warehouses
- Cross border Call-off & Consignment
- (Mini) One Stop Shop
- Various types of Services
- Supply & Install
- Distance selling
- Imports (Deferrals, Import license, Onward EC Sales etc.)
- Establishments, NON-Established businesses
- Etc.

# O Series connects with the world....

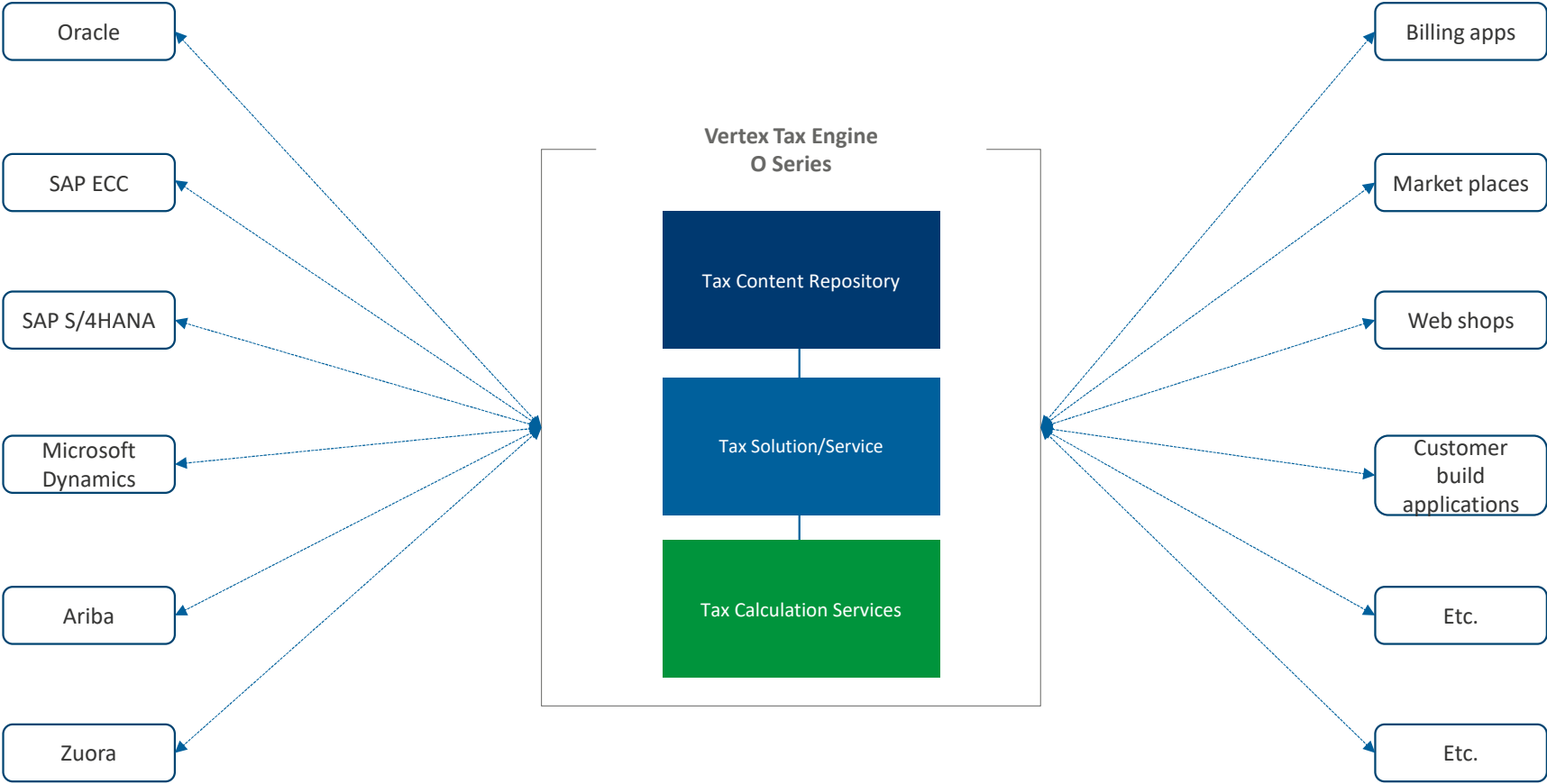

**...but there is no universal language**

# Connecting SAP without a “translator”

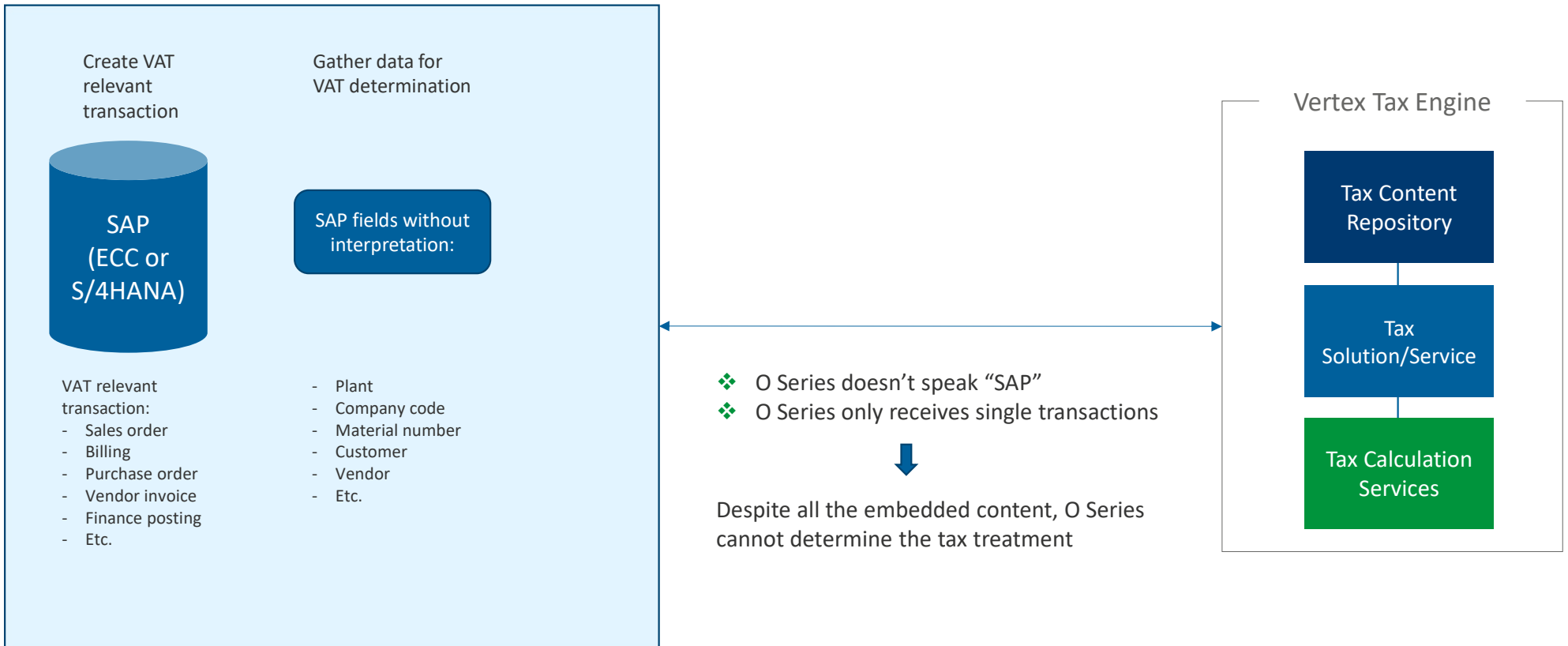

# “Translate” SAP language to O Series language

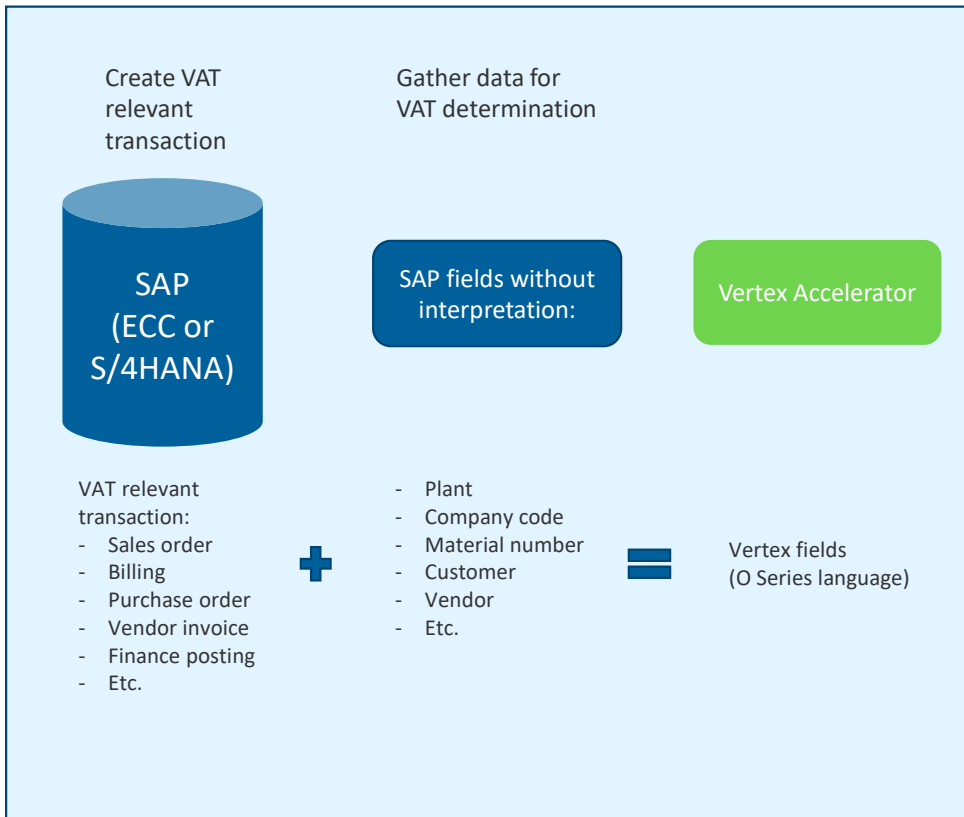

- ❖ O Series now understands “SAP”
- ❖ O Series now understands multiple legs in a transaction



O Series can now determine the correct tax treatment

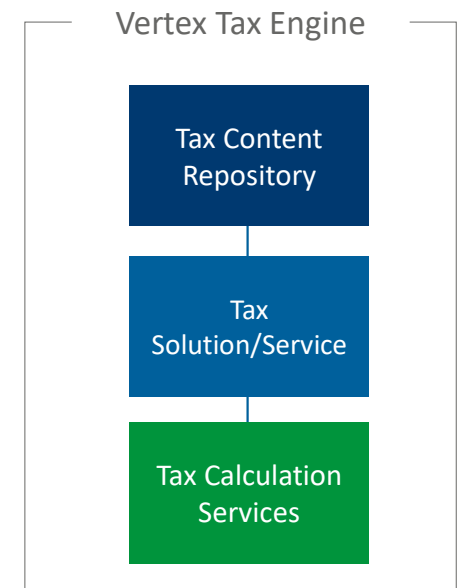
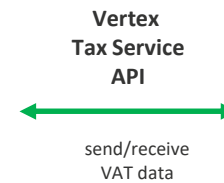

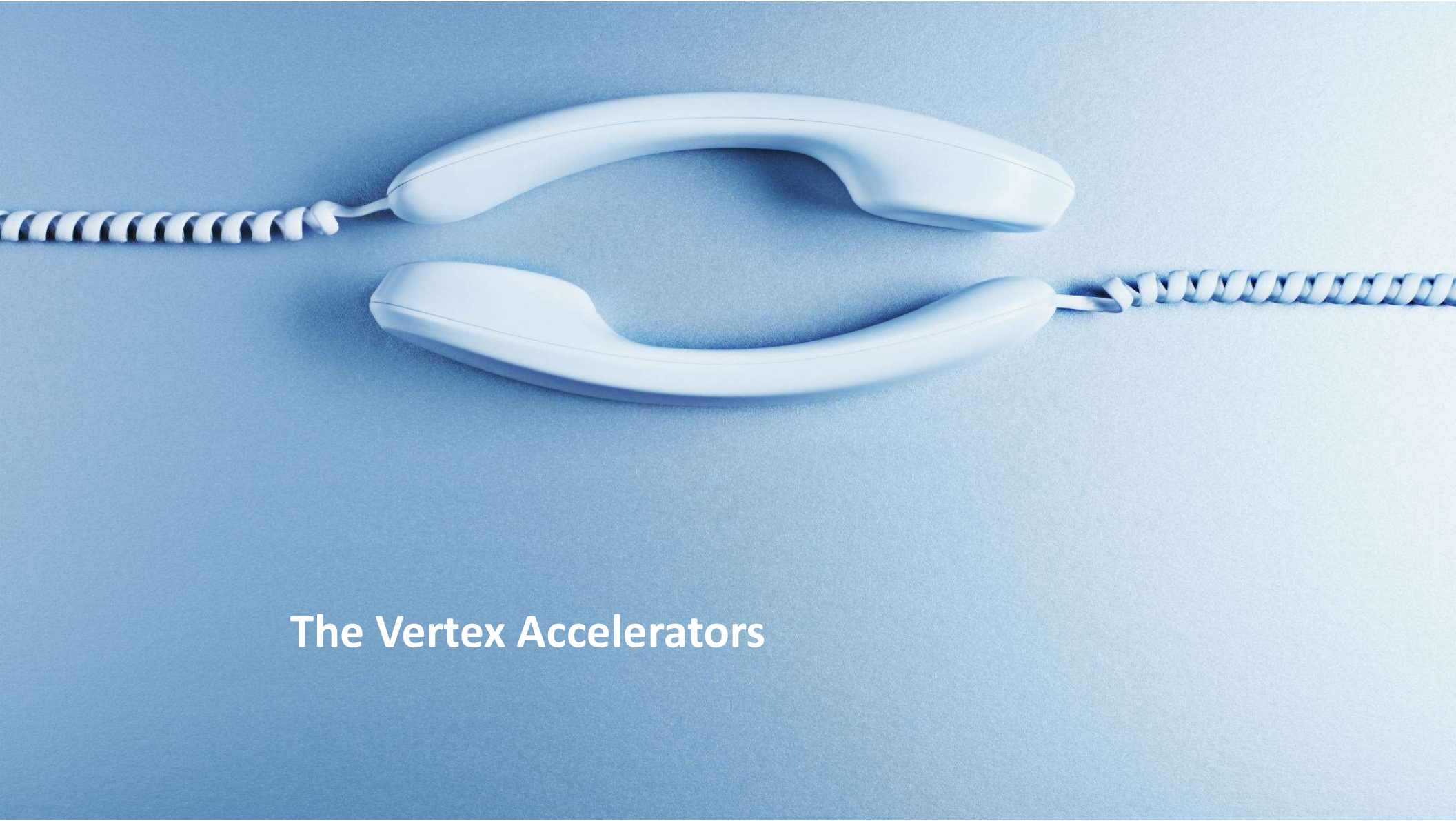

## The Vertex Accelerators



# The Accelerators and their usage

## Accelerator 3.1

- RFC connector with SIC
- Multi jurisdictional countries:
  - US/Canada
  - India
  - Argentina
  - Brazil
  - China
  - Etc.

## Chain Flow Accelerator (CFA)

- Vertex Tax Service (API)
- Single level indirect tax countries:
  - EU
  - APAC (\*)
  - MEA
  - South America's (\*)

(\*) with exception of the countries mentioned under "Accelerator 3.1)

# CFA & Vertex Tax Service

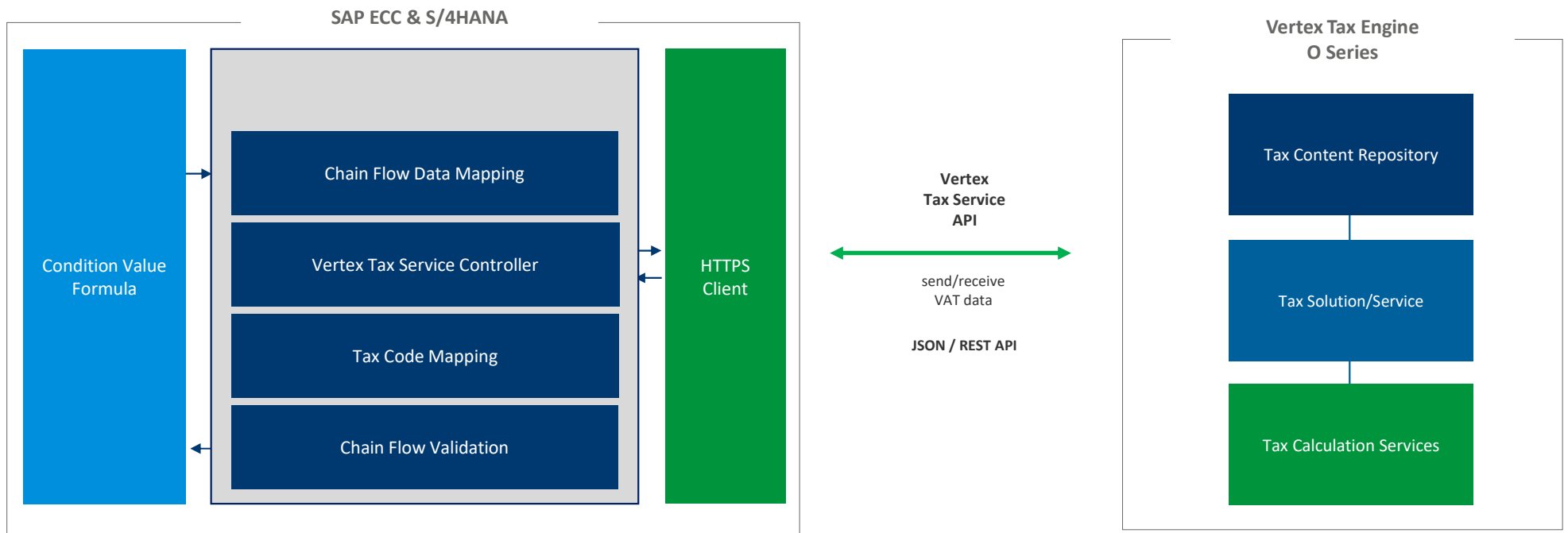

# CFA in SAP

## visualization of the flow in SAP

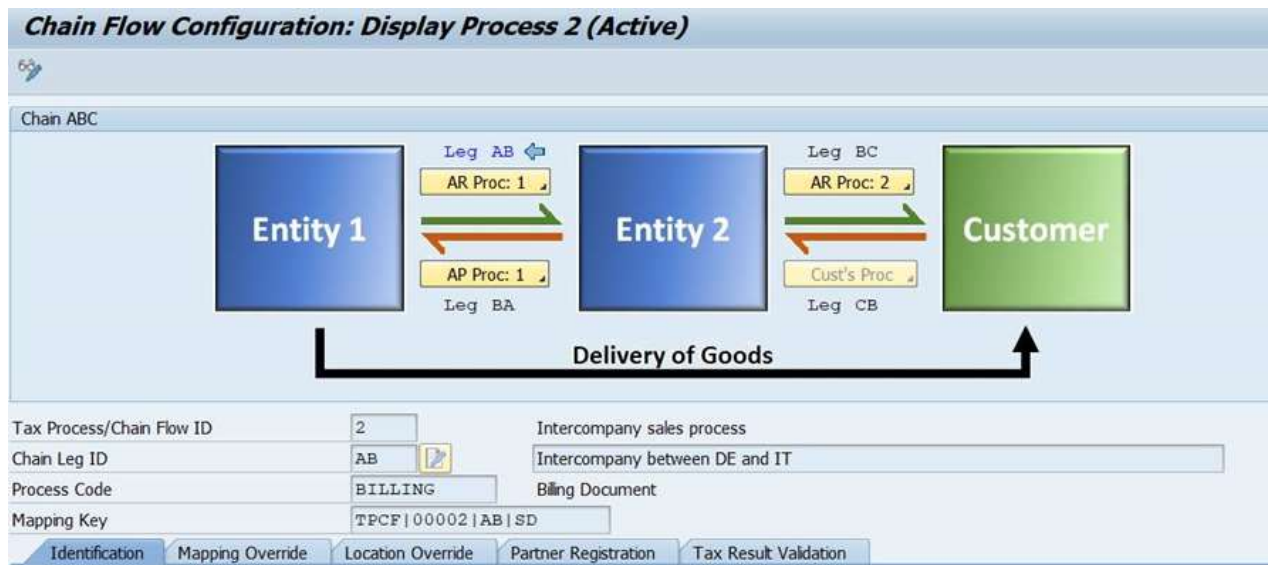

# CFA in SAP

## Chain Flow Tool: Tax Process Chain List

Process ID	Process Code	Chain Leg ID	Tax Process or Chain Description	Number of entity	Activ...	Chain Leg Description
1	BILLING	AB	General Mapping	2	<input checked="" type="checkbox"/>	General Mapping
1	FIAR	AB	General Mapping	2	<input checked="" type="checkbox"/>	General Mapping
1	SD	AB	General Mapping	2	<input checked="" type="checkbox"/>	General Mapping
1	FIAP	BA	General Mapping	2	<input checked="" type="checkbox"/>	General Mapping
1	LIV	BA	General Mapping	2	<input checked="" type="checkbox"/>	General Mapping
1	MRKO	BA	General Mapping	2	<input checked="" type="checkbox"/>	General Mapping
1	PO	BA	General Mapping	2	<input checked="" type="checkbox"/>	General Mapping
2	BILLING	AB	Intercompany sales process	3	<input checked="" type="checkbox"/>	Intercompany between DE and IT
2	FIAP	BA	Intercompany sales process	3	<input checked="" type="checkbox"/>	Leg BA
2	BILLING	BC	Intercompany sales process	3	<input checked="" type="checkbox"/>	Sales to end customer
2	SD	BC	Intercompany sales process	3	<input checked="" type="checkbox"/>	Sales to end customer
3	BILLING	AB	Process ABC	3	<input checked="" type="checkbox"/>	Intercompany billing: Intra-community Supply
3	FIAP	BA	Process ABC	3	<input checked="" type="checkbox"/>	Intercompany AP invoice: Intra-EU Triangulation
3	BILLING	BC	Process ABC	3	<input checked="" type="checkbox"/>	Sales/Invoice to end customer: Intra-EU Triangulation Outp...
3	SD	BC	Process ABC	3	<input checked="" type="checkbox"/>	Sales/Invoice to end customer: Intra-EU Triangulation Outp...
4	BILLING	CD	High Seas transaction	3	<input type="checkbox"/>	Leg CD
4	SD	CD	High Seas transaction	3	<input type="checkbox"/>	Leg CD

Generic for all flows

Override of generic mapping where necessary

## Q&A together with Sachertorte





Thank You



Roger Lindelauf

Director Europe SAP Center of Excellence



[Roger.Lindelauf@Vertexinc.com](mailto:Roger.Lindelauf@Vertexinc.com)